

CHATHAM COUNTY

SECONDARY SEAL MAP

04-00-2021 12:49 Mar Seels\Chatham-October-2021-AST_Map_Typ.dgn
 11/16/2021 11:16 AM
 11/16/2021 11:16 AM

PROJECT NO.	SHEET NO.	TOTAL NO.
2022CPT.08.10.20192	1a	

SUMMARY OF QUANTITIES

PROJECT NO	COUNTY	MAP NO	ROUTE	DESCRIPTION	TYP NO	LANES	LANE TYPE	FINAL SURFACE TESTING REQUIRED	WARM MIX ASPHALT REQUIRED	LENGTH	WIDTH	1803500000-E	1820000000-E	1838000000-E	1838500000-N	2143000000-E		
												ASPHALT SURFACE TREATMENT, DOUBLE SEAL	ASPHALT SURFACE TREATMENT, FOG SEAL	EMULSION FOR ASPHALT SURFACE TREATMENT	VACUUM TRUCK	BLOTTING SAND		
												MI	FT	SY	SY	GAL	WK	TON
2022CPT.08.10.20192	Chatham	1	SR 1605 (TALL OAKS DR)	FROM SR 1532 (MANN'S CHAPEL RD) TO SR 1625 (HIGHLAND TR)	1	2		NO	NO	0.7	22	9,035.00	9,035.00	4,969				
TOTAL FOR MAP NO. 1										0.7		9,035.00	9,035.00	4,969				
2022CPT.08.10.20192	Chatham	2	SR 1568 (CHATHAM DR)	FROM SR 1532 (MANN'S CHAPEL RD) TO SR 1625 (HIGHLAND TR)	1	2		NO	NO	0.66	22	8,518.00	8,518.00	4,685				
TOTAL FOR MAP NO. 2										0.66		8,518.00	8,518.00	4,685				
2022CPT.08.10.20192	Chatham	3	SR 1569 (JONAN CT)	FROM SR 1568 (CHATHAM DR) TO DEAD END	1	2		NO	NO	0.12	18	1,267.00	1,267.00	697				
TOTAL FOR MAP NO. 3										0.12		1,267.00	1,267.00	697				
2022CPT.08.10.20192	Chatham	4	SR 1625 (HIGHLAND TR)	FROM DEAD END TO DEAD END	1	2		NO	NO	1.65	22	21,296.00	21,296.00	11,713				
TOTAL FOR MAP NO. 4										1.65		21,296.00	21,296.00	11,713				
2022CPT.08.10.20192	Chatham	5	SR 1629 (STONE HILL RD)	FROM SR 1625 (HIGHLAND TR) TO SR 1625 (HIGHLAND TR)	1	2		NO	NO	0.71	22	9,164.00	9,164.00	5,040				
TOTAL FOR MAP NO. 5										0.71		9,164.00	9,164.00	5,040				
2022CPT.08.10.20192	Chatham	6	SR 1632 (EAGLE ROCK CT)	FROM SR 1625 (HIGHLAND TR) TO DEAD END	1	2		NO	NO	0.14	18	1,478.00	1,478.00	813				
TOTAL FOR MAP NO. 6										0.14		1,478.00	1,478.00	813				
2022CPT.08.10.20192	Chatham	7	SR 1626 (VALLEY PL)	FROM SR 1625 (HIGHLAND TR) TO DEAD END	1	2		NO	NO	0.04	19	446.00	446.00	245				
TOTAL FOR MAP NO. 7										0.04		446.00	446.00	245				
2022CPT.08.10.20192	Chatham	8	SR 1636 (MOUNTAIN VIEW RD)	FROM SR 1625 (HIGHLAND TR) TO DEAD END	1	2		NO	NO	0.11	22	1,420.00	1,420.00	781				
TOTAL FOR MAP NO. 8										0.11		1,420.00	1,420.00	781				
2022CPT.08.10.20192	Chatham	9	SR 1637 (GRANITE RIDGE RD)	FROM SR 1568 (CHATHAM DR) TO SR 1625 (HIGHLAND TR)	1	2		NO	NO	0.2	22	2,581.00	2,581.00	1,420				
TOTAL FOR MAP NO. 9										0.2		2,581.00	2,581.00	1,420				
2022CPT.08.10.20192	Chatham	10	SR 1638 (FERNWOOD CT)	FROM SR 1637 (GRANITE RIDGE RD) TO DEAD END	1	2		NO	NO	0.04	21	493.00	493.00	271				
TOTAL FOR MAP NO. 10										0.04		493.00	493.00	271				
2022CPT.08.10.20192	Chatham	11	SR 1627 (TRAILWOOD CT)	FROM SR 1625 (HIGHLAND TR) TO DEAD END	1	2		NO	NO	0.07	19	780.00	780.00	429				
TOTAL FOR MAP NO. 11										0.07		780.00	780.00	429				
2022CPT.08.10.20192	Chatham	12	SR 1628 (TIMBER LN)	FROM SR 1625 (HIGHLAND TR) TO DEAD END	1	2		NO	NO	0.05	18	528.00	528.00	290				
TOTAL FOR MAP NO. 12										0.05		528.00	528.00	290				
2022CPT.08.10.20192	Chatham	13	SR 1631 (WOODBEND CT)	FROM SR 1629 (STONE HILL RD) TO DEAD END	1	2		NO	NO	0.13	19	1,449.00	1,449.00	797				
TOTAL FOR MAP NO. 13										0.13		1,449.00	1,449.00	797				
2022CPT.08.10.20192	Chatham	14	SR 1639 (GREENBRIER CT)	FROM SR 1629 (STONE HILL RD) TO DEAD END	1	2		NO	NO	0.1	20	1,173.00	1,173.00	645				
TOTAL FOR MAP NO. 14										0.1		1,173.00	1,173.00	645				
2022CPT.08.10.20192	Chatham	15	SR 1645 (MARGARET DANIEL LN)	FROM SR 1629 (STONE HILL RD) TO DEAD END	1	2		NO	NO	0.17	22	2,194.00	2,194.00	1,207				
TOTAL FOR MAP NO. 15										0.17		2,194.00	2,194.00	1,207				
2022CPT.08.10.20192	Chatham	16	SR 1646 (DIANA DEL SILVA CT)	FROM SR 1645 (MARGARET DANIEL LN) TO DEAD END	1	2		NO	NO	0.45	19	5,016.00	5,016.00	2,759				

												PROJECT NO.	SHEET NO.	TOTAL NO.	
												2022CPT.08.10.20192	1b		
TOTAL FOR MAP NO. 16												0.45	5,016.00	5,016.00	2,759
2022CPT.08.10.20192	Chatham	17	SR 1647 (DANNING DR)	FROM SR 1645 (MARGARET DANIEL LN) TO END MAINT	1	2		NO	NO	0.23	18	2,429.00	2,429.00	1,336	
TOTAL FOR MAP NO. 17												0.23	2,429.00	2,429.00	1,336
2022CPT.08.10.20192	Chatham	18	SR 1862 (WILDER RIDGE RD)	FROM SR 1721 (LYSTRA RD) TO CULDESAC	1	2		NO	NO	0.2	21	2,464.00	2,464.00	1,355	
TOTAL FOR MAP NO. 18												0.2	2,464.00	2,464.00	1,355
2022CPT.08.10.20192	Chatham	19	SR 1619 (MILES BRANCH)	FROM US 15/501 TO CULDESAC	1	2		NO	NO	0.36	19	4,013.00	4,013.00	2,207	
TOTAL FOR MAP NO. 19												0.36	4,013.00	4,013.00	2,207
2022CPT.08.10.20192	Chatham	20	SR 1620 (LONNA CT)	FROM SR 1619 (MILES BRANCH) TO CULDESAC	1	2		NO	NO	0.2	19	2,229.00	2,229.00	1,226	
TOTAL FOR MAP NO. 20												0.2	2,229.00	2,229.00	1,226
2022CPT.08.10.20192	Chatham	21	SR 1641 (LAUREN CT)	FROM SR 1619 (MILES BRANCH) TO CULDESAC	1	2		NO	NO	0.09	19	1,003.00	1,003.00	552	
TOTAL FOR MAP NO. 21												0.09	1,003.00	1,003.00	552
2022CPT.08.10.20192	Chatham	22	SR 1642 (CARSON CT)	FROM SR 1619 (MILES BRANCH) TO CULDESAC	1	2		NO	NO	0.13	18	1,449.00	1,449.00	797	
TOTAL FOR MAP NO. 22												0.13	1,449.00	1,449.00	797
2022CPT.08.10.20192	Chatham	23	SR 1707 (CHARLIE FIELDS RD)	FROM SR 1524 (DURHAM EUBANKS RD) TO SR 1713 (BYNUM RD)	1	2		NO	NO	0.23	18	2,429.00	2,429.00	1,336	
TOTAL FOR MAP NO. 23												0.23	2,429.00	2,429.00	1,336
2022CPT.08.10.20192	Chatham	24	SR 1708 (DIXON RD)	FROM SR 1524 (DURHAM EUBANKS RD) TO SR 1707 (CHARLIE FIELDS RD)	1	2		NO	NO	0.12	18	1,267.00	1,267.00	697	
TOTAL FOR MAP NO. 24												0.12	1,267.00	1,267.00	697
2022CPT.08.10.20192	Chatham	25	SR 1654 (OLDE FARM RD)	FROM SR 1520 (RUSSELLS CHAPEL RD) TO CULDESAC	1	2		NO	NO	0.19	18	2,006.00	2,006.00	1,104	
TOTAL FOR MAP NO. 25												0.19	2,006.00	2,006.00	1,104
2022CPT.08.10.20192	Chatham	26	SR 1519 (MILLIKEN RD)	FROM SR 1520 (RUSSELLS CHAPEL RD) TO DEAD END	1	2		NO	NO	0.3	19	3,344.00	3,344.00	1,839	
TOTAL FOR MAP NO. 26												0.3	3,344.00	3,344.00	1,839
2022CPT.08.10.20192	Chatham	27	SR 1613 (WOODBIDGE DR)	FROM US 15/501 TO CULDESAC	1	2		NO	NO	0.38	20	4,459.00	4,459.00	2,452	
TOTAL FOR MAP NO. 27												0.38	4,459.00	4,459.00	2,452
2022CPT.08.10.20192	Chatham	28	SR 1614 (HARDIN CIR)	FROM SR 1613 (WOODBIDGE CT) TO CULDESAC	1	2		NO	NO	0.07	20	821.00	821.00	452	
TOTAL FOR MAP NO. 28												0.07	821.00	821.00	452
2022CPT.08.10.20192	Chatham	29	SR 1615 (BELL CIR)	FROM SR 1613 (WOODBIDGE CT) TO CULDESAC	1	2		NO	NO	0.09	21	1,109.00	1,109.00	610	
TOTAL FOR MAP NO. 29												0.09	1,109.00	1,109.00	610
2022CPT.08.10.20192	Chatham	30	SR 1672 (GROVE PARK CIR)	SR 1670 (HEARTLAND DR) TO SR 1672 (GROVE PARK CIR)	1	2		NO	NO	0.52	20	6,101.00	6,101.00	3,356	
TOTAL FOR MAP NO. 30												0.52	6,101.00	6,101.00	3,356
2022CPT.08.10.20192	Chatham	31	SR 1616 (BURNETT CIR)	FROM SR 1540 (JONES FERRY RD) TO DEAD END	2	2		NO	NO	0.51	19	5,685.00		3,127	
TOTAL FOR MAP NO. 31												0.51	5,685.00		3,127
2022CPT.08.10.20192	Chatham	32	SR 1988 (SHADDOX DR)	FROM SR 1972 (PEA RIDGE RD) TO CULDESAC	2	2		NO	NO	0.41	18	4,330.00		2,381	
TOTAL FOR MAP NO. 32												0.41	4,330.00		2,381
2022CPT.08.10.20192	Chatham	33	SR 1761 (CALEY WILSON RD)	FROM NC 751 TO DEAD END	2	2		NO	NO	0.35	18	3,696.00		2,033	
TOTAL FOR MAP NO. 33												0.35	3,696.00		2,033
2022CPT.08.10.20192	Chatham	34	SR 1571 (SOLOMON DEGRAFFENREID RD)	FROM NC 87 TO DEAD END	2	2		NO	NO	0.69	20	8,096.00		4,453	
TOTAL FOR MAP NO. 34												0.69	8,096.00		4,453
2022CPT.08.10.20192	Chatham	35	SR 1515 (OLD SILER CITY RD)	FROM SR 1564 (OLD SILER CITY RD) TO US 64 BUS	2	2		NO	NO	0.41	20	4,811.00		2,646	

											PROJECT NO.	SHEET NO.	TOTAL NO.			
											2022CPT.08.10.20192	1c				
TOTAL FOR MAP NO. 35											0.41		4,811.00		2,646	
2022CPT.08.10.20192	Chatham	36	SR 1564 (OLD SILER CITY RD)	FROM SR 1515 (MITCHELLS CHAPEL RD) TO CULDESAC	2	2		NO	NO	0.81	19	9,029.00		4,966		
TOTAL FOR MAP NO. 36											0.81		9,029.00		4,966	
2022CPT.08.10.20192	Chatham	37	SR 1706 (BYNUM BEACH RD)	FROM SR 1876 (BYNUM RD) TO DEAD END	2	2		NO	NO	0.15	19	1,584.00		871		
TOTAL FOR MAP NO. 37											0.15		1,584.00		871	
2022CPT.08.10.20192	Chatham	38	SR 1648 (PLANTATION DR)	FROM SR 1514 (MANCO DAIRY RD) TO DEAD END	2	2		NO	NO	0.33	23	4,453.00		2,449		
TOTAL FOR MAP NO. 38											0.33		4,453.00		2,449	
2022CPT.08.10.20192	Chatham	39	SR 1514 (MANCO DAIRY RD)	FROM US 64 TO END PVMT	2	2		NO	NO	0.07	23	945.00		519		
TOTAL FOR MAP NO. 39											0.07		945.00		519	
2022CPT.08.10.20192	Chatham	40	SR 1547 (ROCK REST RD)	FROM SR 1520 (OLD GRAHAM RD) TO END MAINT	2	2		NO	NO	0.51	21	6,283.00		3,456		
TOTAL FOR MAP NO. 40											0.51		6,283.00		3,456	
2022CPT.08.10.20192	Chatham	41	SR 1549 (CASTLE ROCK FARM RD)	FROM SR 1549 (CASTLE ROCK FARM RD) TO NC 87	2	2		NO	NO	1.39	21	17,125.00		9,419		
TOTAL FOR MAP NO. 41											1.39		17,125.00		9,419	
2022CPT.08.10.20192	Chatham	42	SR 1546 (E PERRY RD)	FROM NC 87 TO END MAINT	2	2		NO	NO	0.81	21	9,979.00		5,489		
TOTAL FOR MAP NO. 42											0.81		9,979.00		5,489	
2022CPT.08.10.20192	Chatham	43	SR 1548 (LUTTERLOH RD)	FROM NC 87 TO END PVMT	2	2		NO	NO	1.41	20	16,544.00		9,099		
TOTAL FOR MAP NO. 43											1.41		16,544.00		9,099	
2022CPT.08.10.20192	Chatham	44	SR 1783 (HUDSON HILLS RD)	FROM SR 1711 (BYNUM RIDGE RD) TO END MAINT	2	2		NO	NO	0.66	20	7,744.00		4,259		
TOTAL FOR MAP NO. 44											0.66		7,744.00		4,259	
2022CPT.08.10.20192	Chatham	45	SR 1784 (TRIPP RD)	FROM SR 1783 (HUDSON HILLS RD) TO CULDESAC	2	2		NO	NO	0.14	20	1,643.00		903		
TOTAL FOR MAP NO. 45											0.14		1,643.00		903	
2022CPT.08.10.20192	Chatham	46	SR 1553 (VAN THOMAS RD)	FROM SR 1003 (SILK HOPE LINDLEY MILLS RD) TO SR 1549 (CASTLE ROCK FARM RD)	2	2		NO	NO	2.65	21	32,648.00		17,956	16.00 25	
TOTAL FOR MAP NO. 46											2.65		32,648.00		17,956	16.00 25
2022CPT.08.10.20192	Chatham	47	SR 1560 (WR CLARK RD)	FROM BEGIN PVMT TO SR 1346 (SILK HOPE GUM SPRINGS RD)	2	2		NO	NO	0.75	20	8,800.00		4,840		
TOTAL FOR MAP NO. 47											0.75		8,800.00		4,840	
2022CPT.08.10.20192	Chatham	48	SR 1508 (CLARK SELF RD)	FROM SR 1509 (LAURA JOHNSON RD) TO SR 1346 (SILK HOPE GUM SPRINGS RD)	2	2		NO	NO	1.26	21	15,523.00		8,538		
TOTAL FOR MAP NO. 48											1.26		15,523.00		8,538	
2022CPT.08.10.20192	Chatham	49	SR 1544 (LASHLEY RD - LOOPS)	FROM SR 1539 (CRAWFORD DAIRY RD) TO SR 1539 (CRAWFORD DAIRY RD)	2	2		NO	NO	1.08	21	13,306.00		7,318		
TOTAL FOR MAP NO. 49											1.08		13,306.00		7,318	
TOTAL FOR PROJ NO. 2022CPT.08.10.20192											22.84		274,185.00	101,961.00	150,802	16.00 25
GRAND TOTAL											22.84		274,185.00	101,961.00	150,802	16.00 25

PROJECT NO.	SHEET NO.	TOTAL NO.
2022CPT.08.10.20192	1d	

THERMOPLASTIC AND PAINT QUANTITIES

PROJECT NO	COUNTY	MAP NO	ROUTE	DESCRIPTION	TYP NO	LANES	LANE TYPE	LENGTH	WIDTH	4413000000-E WORK ZONE ADVANCE/GE NERAL WARNING SIGNING	4457000000-N TEMPORARY TRAFFIC CONTROL
								MI	FT	SF	LS
2022CPT.08.10.20192	Chatham	1	SR 1605 (TALL OAKS DR)	FROM SR 1532 (MANNS CHAPEL RD) TO SR 1625 (HIGHLAND TR)	1	2		0.7	22	80	
TOTAL FOR MAP NO. 1								0.7		80	
2022CPT.08.10.20192	Chatham	2	SR 1568 (CHATHAM DR)	FROM SR 1532 (MANNS CHAPEL RD) TO SR 1625 (HIGHLAND TR)	1	2		0.66	22	75	
TOTAL FOR MAP NO. 2								0.66		75	
2022CPT.08.10.20192	Chatham	3	SR 1569 (JONAN CT)	FROM SR 1568 (CHATHAM DR) TO DEAD END	1	2		0.12	18	15	
TOTAL FOR MAP NO. 3								0.12		15	
2022CPT.08.10.20192	Chatham	4	SR 1625 (HIGHLAND TR)	FROM DEAD END TO DEAD END	1	2		1.65	22	185	
TOTAL FOR MAP NO. 4								1.65		185	
2022CPT.08.10.20192	Chatham	5	SR 1629 (STONE HILL RD)	FROM SR 1625 (HIGHLAND TR) TO SR 1625 (HIGHLAND TR)	1	2		0.71	22	80	
TOTAL FOR MAP NO. 5								0.71		80	
2022CPT.08.10.20192	Chatham	6	SR 1632 (EAGLE ROCK CT)	FROM SR 1625 (HIGHLAND TR) TO DEAD END	1	2		0.14	18	20	
TOTAL FOR MAP NO. 6								0.14		20	
2022CPT.08.10.20192	Chatham	7	SR 1626 (VALLEY PL)	FROM SR 1625 (HIGHLAND TR) TO DEAD END	1	2		0.04	19	5	
TOTAL FOR MAP NO. 7								0.04		5	
2022CPT.08.10.20192	Chatham	8	SR 1636 (MOUNTAIN VIEW RD)	FROM SR 1625 (HIGHLAND TR) TO DEAD END	1	2		0.11	22	15	
TOTAL FOR MAP NO. 8								0.11		15	
2022CPT.08.10.20192	Chatham	9	SR 1637 (GRANITE RIDGE RD)	FROM SR 1568 (CHATHAM DR) TO SR 1625 (HIGHLAND TR)	1	2		0.2	22	25	
TOTAL FOR MAP NO. 9								0.2		25	
2022CPT.08.10.20192	Chatham	10	SR 1638 (FERNWOOD CT)	FROM SR 1637 (GRANITE RIDGE RD) TO DEAD END	1	2		0.04	21	5	
TOTAL FOR MAP NO. 10								0.04		5	
2022CPT.08.10.20192	Chatham	11	SR 1627 (TRAILWOOD CT)	FROM SR 1625 (HIGHLAND TR) TO DEAD END	1	2		0.07	19	10	
TOTAL FOR MAP NO. 11								0.07		10	
2022CPT.08.10.20192	Chatham	12	SR 1628 (TIMBER LN)	FROM SR 1625 (HIGHLAND TR) TO DEAD END	1	2		0.05	18	10	
TOTAL FOR MAP NO. 12								0.05		10	
2022CPT.08.10.20192	Chatham	13	SR 1631 (WOODBEND CT)	FROM SR 1629 (STONE HILL RD) TO DEAD END	1	2		0.13	19	15	
TOTAL FOR MAP NO. 13								0.13		15	
2022CPT.08.10.20192	Chatham	14	SR 1639 (GREENBRIER CT)	FROM SR 1629 (STONE HILL RD) TO DEAD END	1	2		0.1	20	15	
TOTAL FOR MAP NO. 14								0.1		15	
2022CPT.08.10.20192	Chatham	15	SR 1645 (MARGARET DANIEL LN)	FROM SR 1629 (STONE HILL RD) TO DEAD END	1	2		0.17	22	20	
TOTAL FOR MAP NO. 15								0.17		20	

							PROJECT NO.	SHEET NO.	TOTAL NO.
							2022CPT.08.10.20192	1e	
2022CPT.08.10.20192	Chatham	16	SR 1646 (DIANA DEL SILVA CT)	FROM SR 1645 (MARGARET DANIEL LN) TO DEAD END	1	2	0.45	19	55
TOTAL FOR MAP NO. 16							0.45		55
2022CPT.08.10.20192	Chatham	17	SR 1647 (DANNING DR)	FROM SR 1645 (MARGARET DANIEL LN) TO END MAINT	1	2	0.23	18	30
TOTAL FOR MAP NO. 17							0.23		30
2022CPT.08.10.20192	Chatham	18	SR 1862 (WILDER RIDGE RD)	FROM SR 1721 (LYSTRA RD) TO CULDESAC	1	2	0.2	21	25
TOTAL FOR MAP NO. 18							0.2		25
2022CPT.08.10.20192	Chatham	19	SR 1619 (MILES BRANCH)	FROM US 15/501 TO CULDESAC	1	2	0.36	19	45
TOTAL FOR MAP NO. 19							0.36		45
2022CPT.08.10.20192	Chatham	20	SR 1620 (LONNA CT)	FROM SR 1619 (MILES BRANCH) TO CULDESAC	1	2	0.2	19	25
TOTAL FOR MAP NO. 20							0.2		25
2022CPT.08.10.20192	Chatham	21	SR 1641 (LAUREN CT)	FROM SR 1619 (MILES BRANCH) TO CULDESAC	1	2	0.09	19	15
TOTAL FOR MAP NO. 21							0.09		15
2022CPT.08.10.20192	Chatham	22	SR 1642 (CARSON CT)	FROM SR 1619 (MILES BRANCH) TO CULDESAC	1	2	0.13	18	15
TOTAL FOR MAP NO. 22							0.13		15
2022CPT.08.10.20192	Chatham	23	SR 1707 (CHARLIE FIELDS RD)	FROM SR 1524 (DURHAM EUBANKS RD) TO SR 1713 (BYNUM RD)	1	2	0.23	18	30
TOTAL FOR MAP NO. 23							0.23		30
2022CPT.08.10.20192	Chatham	24	SR 1708 (DIXON RD)	FROM SR 1524 (DURHAM EUBANKS RD) TO SR 1707 (CHARLIE FIELDS RD)	1	2	0.12	18	15
TOTAL FOR MAP NO. 24							0.12		15
2022CPT.08.10.20192	Chatham	25	SR 1654 (OLDE FARM RD)	FROM SR 1520 (RUSSELLS CHAPEL RD) TO CULDESAC	1	2	0.19	18	25
TOTAL FOR MAP NO. 25							0.19		25
2022CPT.08.10.20192	Chatham	26	SR 1519 (MILLIKEN RD)	FROM SR 1520 (RUSSELLS CHAPEL RD) TO DEAD END	1	2	0.3	19	35
TOTAL FOR MAP NO. 26							0.3		35
2022CPT.08.10.20192	Chatham	27	SR 1613 (WOODBIDGE DR)	FROM US 15/501 TO CULDESAC	1	2	0.38	20	45
TOTAL FOR MAP NO. 27							0.38		45
2022CPT.08.10.20192	Chatham	28	SR 1614 (HARDIN CIR)	FROM SR 1613 (WOODBIDGE CT) TO CULDESAC	1	2	0.07	20	10
TOTAL FOR MAP NO. 28							0.07		10
2022CPT.08.10.20192	Chatham	29	SR 1615 (BELL CIR)	FROM SR 1613 (WOODBIDGE CT) TO CULDESAC	1	2	0.09	21	15
TOTAL FOR MAP NO. 29							0.09		15
2022CPT.08.10.20192	Chatham	30	SR 1672 (GROVE PARK CIR)	SR 1670 (HEARTLAND DR) TO SR 1672 (GROVE PARK CIR)	1	2	0.52	20	60
TOTAL FOR MAP NO. 30							0.52		60
2022CPT.08.10.20192	Chatham	31	SR 1616 (BURNETT CIR)	FROM SR 1540 (JONES FERRY RD) TO DEAD END	2	2	0.51	19	60
TOTAL FOR MAP NO. 31							0.51		60
2022CPT.08.10.20192	Chatham	32	SR 1988 (SHADDOX DR)	FROM SR 1972 (PEA RIDGE RD) TO CULDESAC	2	2	0.41	18	50
TOTAL FOR MAP NO. 32							0.41		50
2022CPT.08.10.20192	Chatham	33	SR 1761 (CALEY WILSON RD)	FROM NC 751 TO DEAD END	2	2	0.35	18	40
TOTAL FOR MAP NO. 33							0.35		40
2022CPT.08.10.20192	Chatham	34	SR 1571 (SOLOMON DEGRAFFENREID RD)	FROM NC 87 TO DEAD END	2	2	0.69	20	80
TOTAL FOR MAP NO. 34							0.69		80

							PROJECT NO.	SHEET NO.	TOTAL NO.	
							2022CPT.08.10.20192	1f		
2022CPT.08.10.20192	Chatham	35	SR 1515 (OLD SILER CITY RD)	FROM SR 1564 (OLD SILER CITY RD) TO US 64 BUS	2	2	0.41	20	50	
TOTAL FOR MAP NO. 35							0.41		50	
2022CPT.08.10.20192	Chatham	36	SR 1564 (OLD SILER CITY RD)	FROM SR 1515 (MITCHELLS CHAPEL RD) TO CULDESAC	2	2	0.81	19	95	
TOTAL FOR MAP NO. 36							0.81		95	
2022CPT.08.10.20192	Chatham	37	SR 1706 (BYNUM BEACH RD)	FROM SR 1876 (BYNUM RD) TO DEAD END	2	2	0.15	19	20	
TOTAL FOR MAP NO. 37							0.15		20	
2022CPT.08.10.20192	Chatham	38	SR 1648 (PLANTATION DR)	FROM SR 1514 (MANCO DAIRY RD) TO DEAD END	2	2	0.33	23	40	
TOTAL FOR MAP NO. 38							0.33		40	
2022CPT.08.10.20192	Chatham	39	SR 1514 (MANCO DAIRY RD)	FROM US 64 TO END PVMT	2	2	0.07	23	10	
TOTAL FOR MAP NO. 39							0.07		10	
2022CPT.08.10.20192	Chatham	40	SR 1547 (ROCK REST RD)	FROM SR 1520 (OLD GRAHAM RD) TO END MAINT	2	2	0.51	21	60	
TOTAL FOR MAP NO. 40							0.51		60	
2022CPT.08.10.20192	Chatham	41	SR 1549 (CASTLE ROCK FARM RD)	FROM SR 1549 (CASTLE ROCK FARM RD) TO NC 87	2	2	1.39	21	160	
TOTAL FOR MAP NO. 41							1.39		160	
2022CPT.08.10.20192	Chatham	42	SR 1546 (E PERRY RD)	FROM NC 87 TO END MAINT	2	2	0.81	21	95	
TOTAL FOR MAP NO. 42							0.81		95	
2022CPT.08.10.20192	Chatham	43	SR 1548 (LUTTERLOH RD)	FROM NC 87 TO END PVMT	2	2	1.41	20	160	
TOTAL FOR MAP NO. 43							1.41		160	
2022CPT.08.10.20192	Chatham	44	SR 1783 (HUDSON HILLS RD)	FROM SR 1711 (BYNUM RIDGE RD) TO END MAINT	2	2	0.66	20	75	
TOTAL FOR MAP NO. 44							0.66		75	
2022CPT.08.10.20192	Chatham	45	SR 1784 (TRIPP RD)	FROM SR 1783 (HUDSON HILLS RD) TO CULDESAC	2	2	0.14	20	20	
TOTAL FOR MAP NO. 45							0.14		20	
2022CPT.08.10.20192	Chatham	46	SR 1553 (VAN THOMAS RD)	FROM SR 1003 (SILK HOPE LINDLEY MILLS RD) TO SR 1549 (CASTLE ROCK FARM RD)	2	2	2.65	21	385	1.0000
TOTAL FOR MAP NO. 46							2.65		385	1
2022CPT.08.10.20192	Chatham	47	SR 1560 (WR CLARK RD)	FROM BEGIN PVMT TO SR 1346 (SILK HOPE GUM SPRINGS RD)	2	2	0.75	20	145	
TOTAL FOR MAP NO. 47							0.75		145	
2022CPT.08.10.20192	Chatham	48	SR 1508 (CLARK SELF RD)	FROM SR 1509 (LAURA JOHNSON RD) TO SR 1346 (SILK HOPE GUM SPRINGS RD)	2	2	1.26	21	145	
TOTAL FOR MAP NO. 48							1.26		145	
2022CPT.08.10.20192	Chatham	49	SR 1544 (LASHLEY RD - LOOPS)	FROM SR 1539 (CRAWFORD DAIRY RD) TO SR 1539 (CRAWFORD DAIRY RD)	2	2	1.08	21	125	
TOTAL FOR MAP NO. 49							1.08		125	
TOTAL FOR PROJ NO. 2022CPT.08.10.20192							22.84		2,835	1
GRAND TOTAL							22.84		2,835	1

Maps 1-17

Map 18

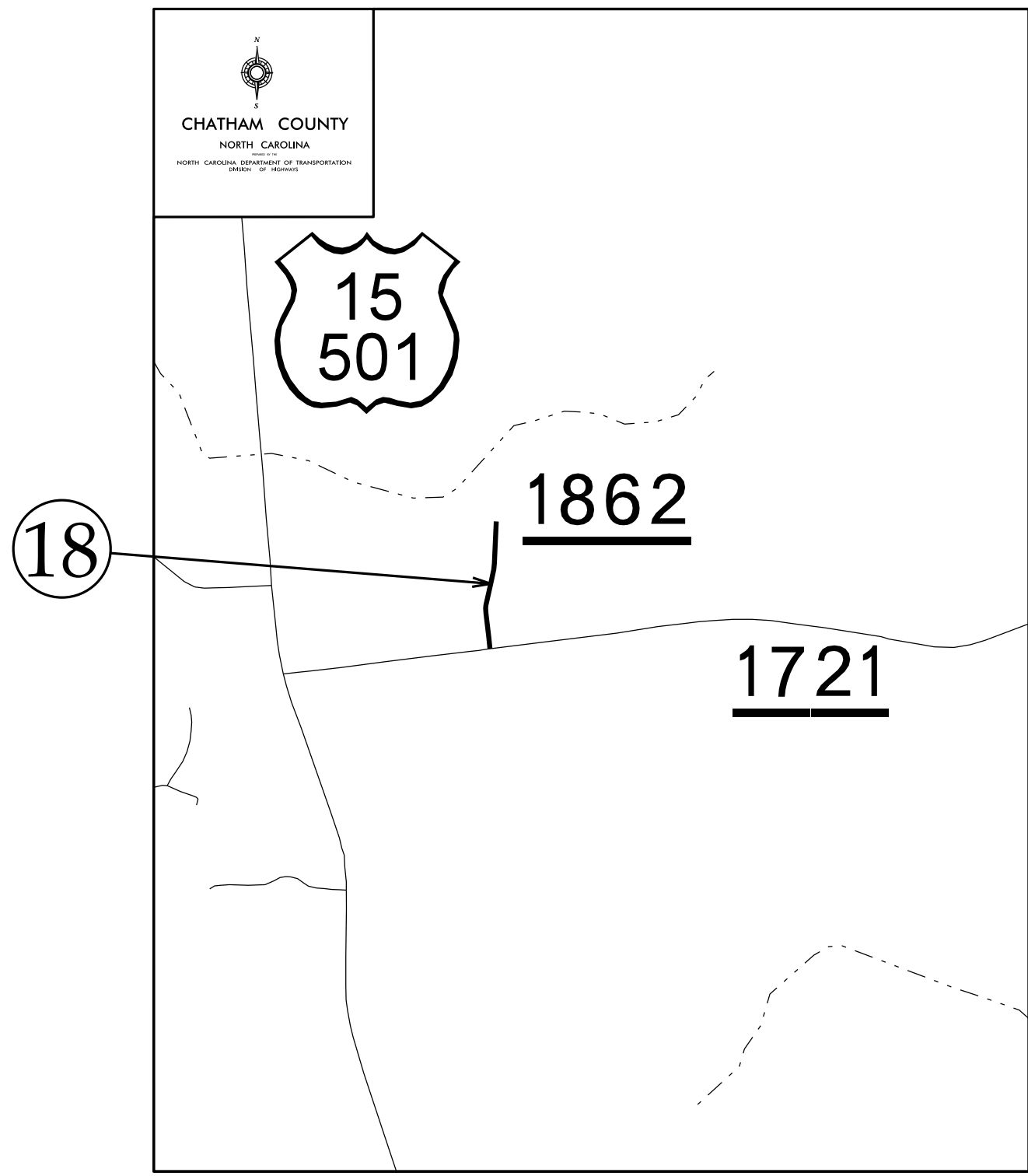
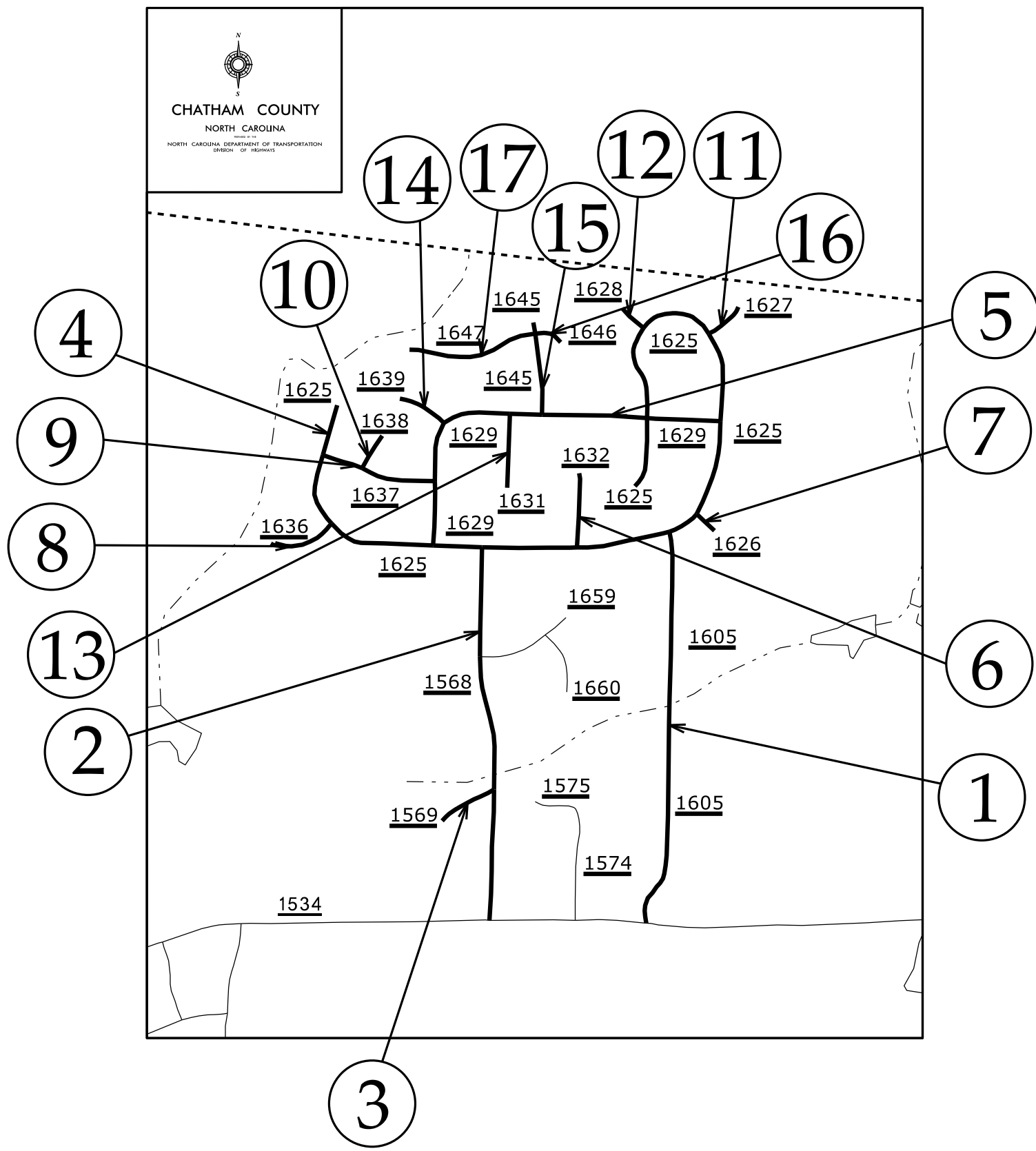

040397
04-001-2021-12-19 Mar Seals\Chatham-October-2021-AST-Chatham-October-2021-AST_Map_Typ.dgn

Maps 27-29

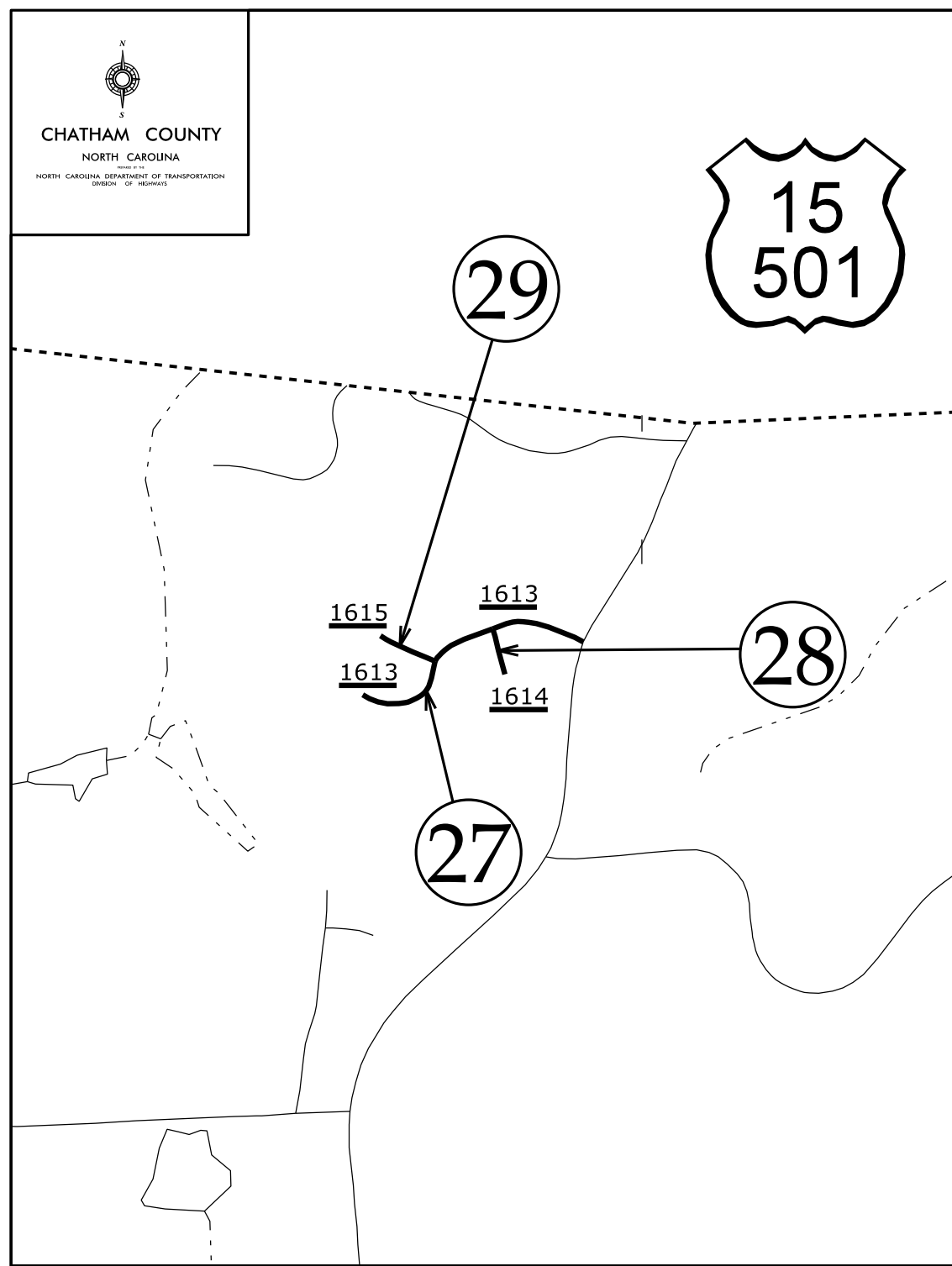

Maps 19-24, 37

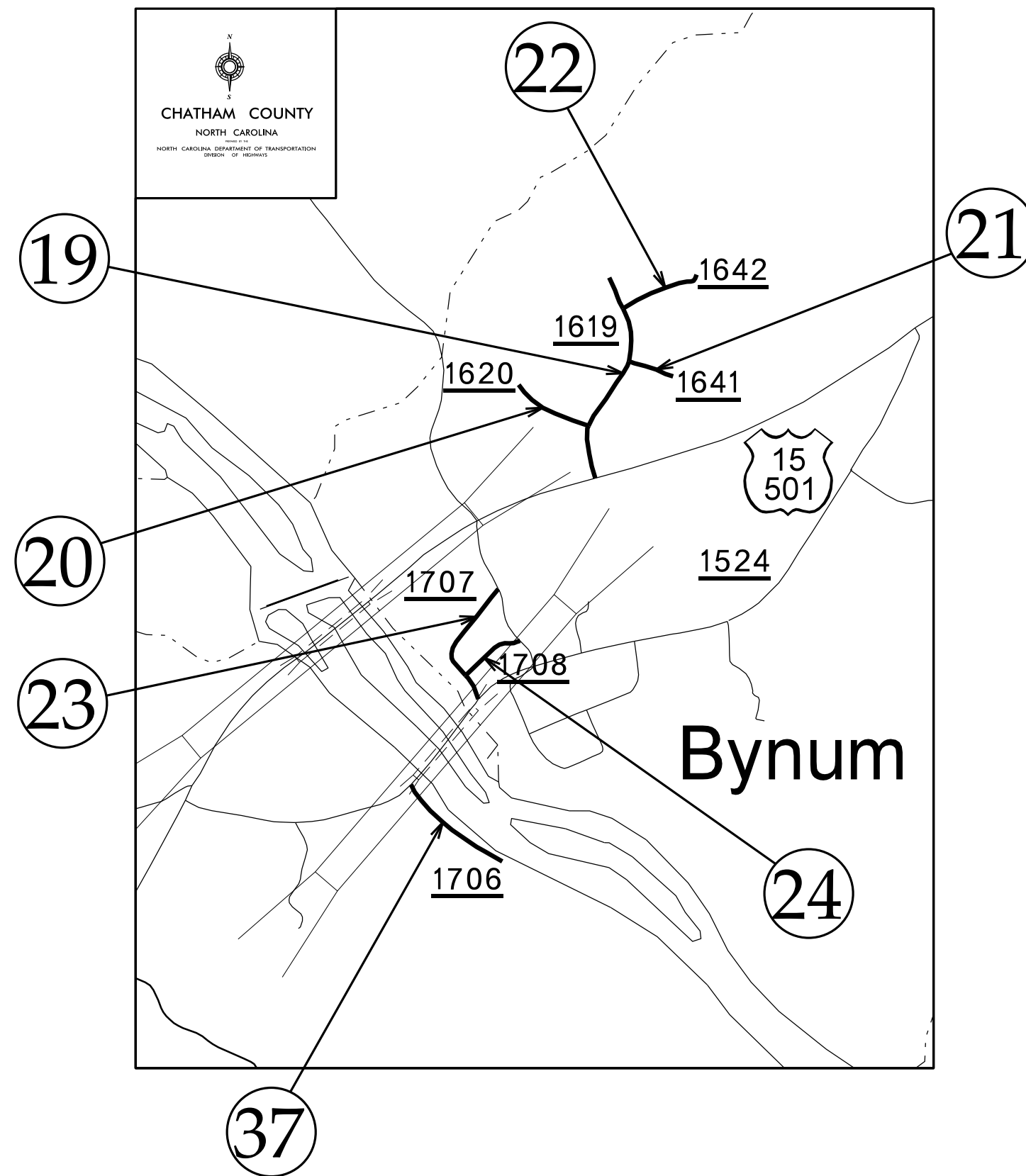

Maps 25,26,34

Map 32

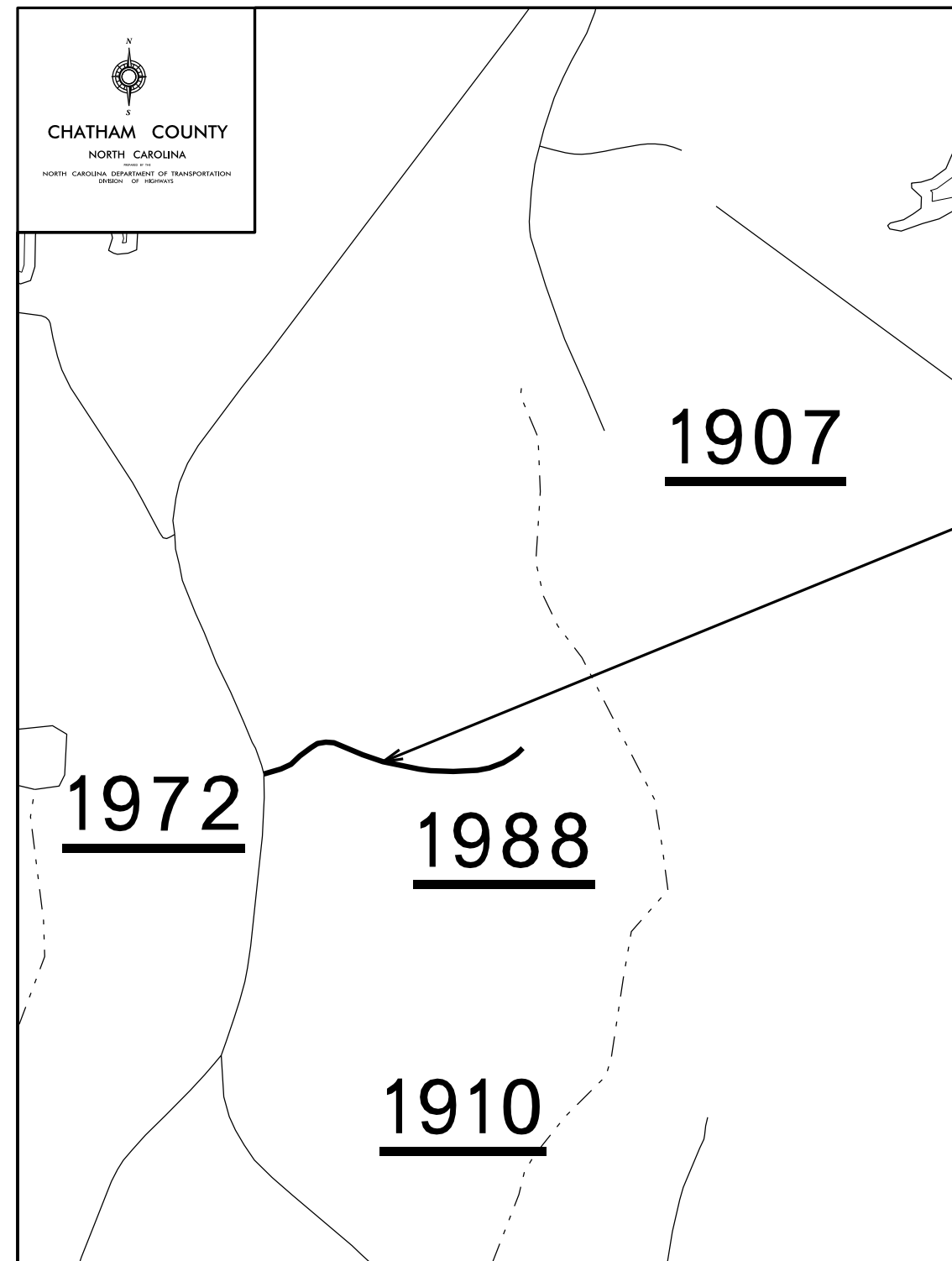
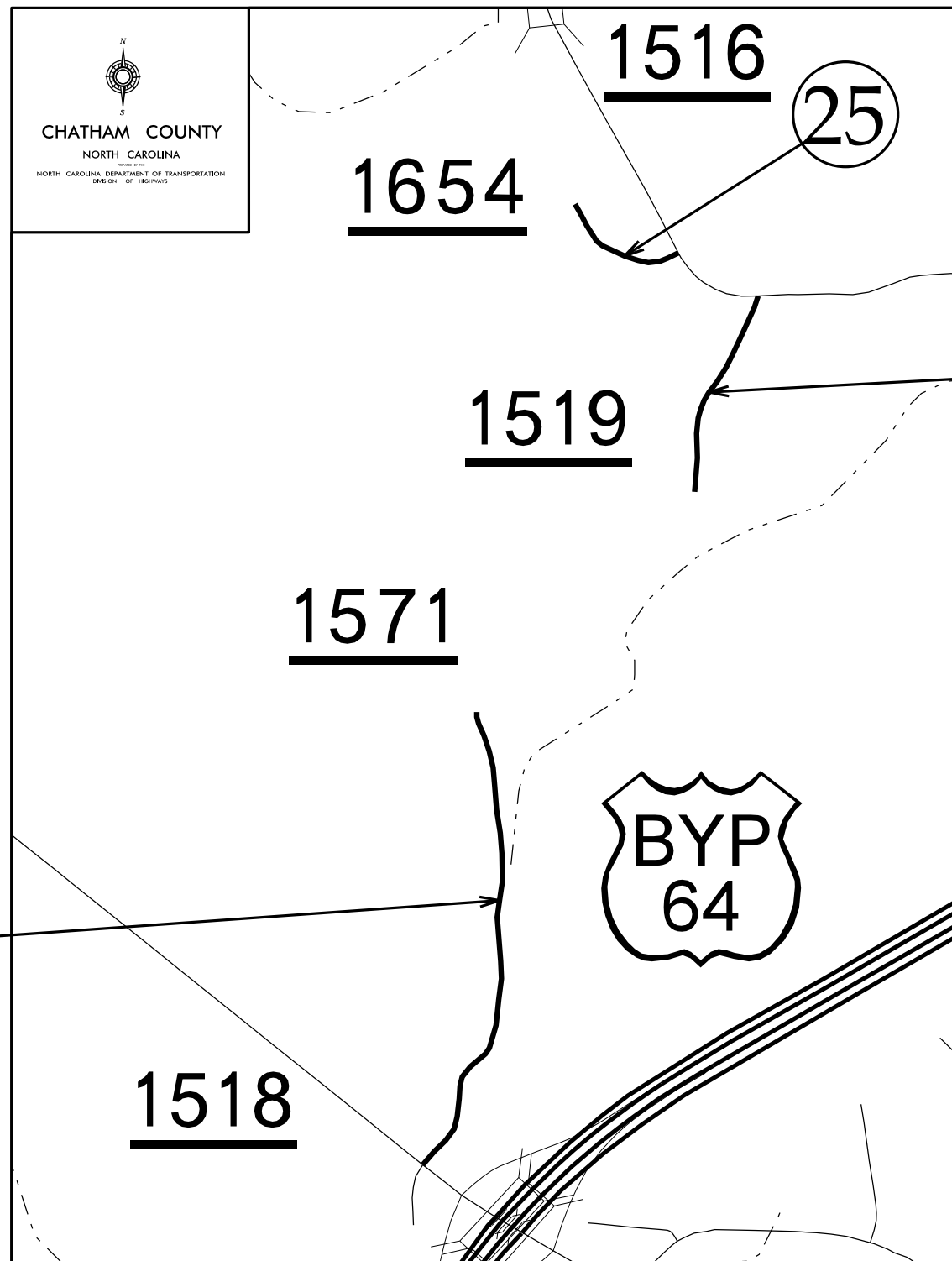

Map 30

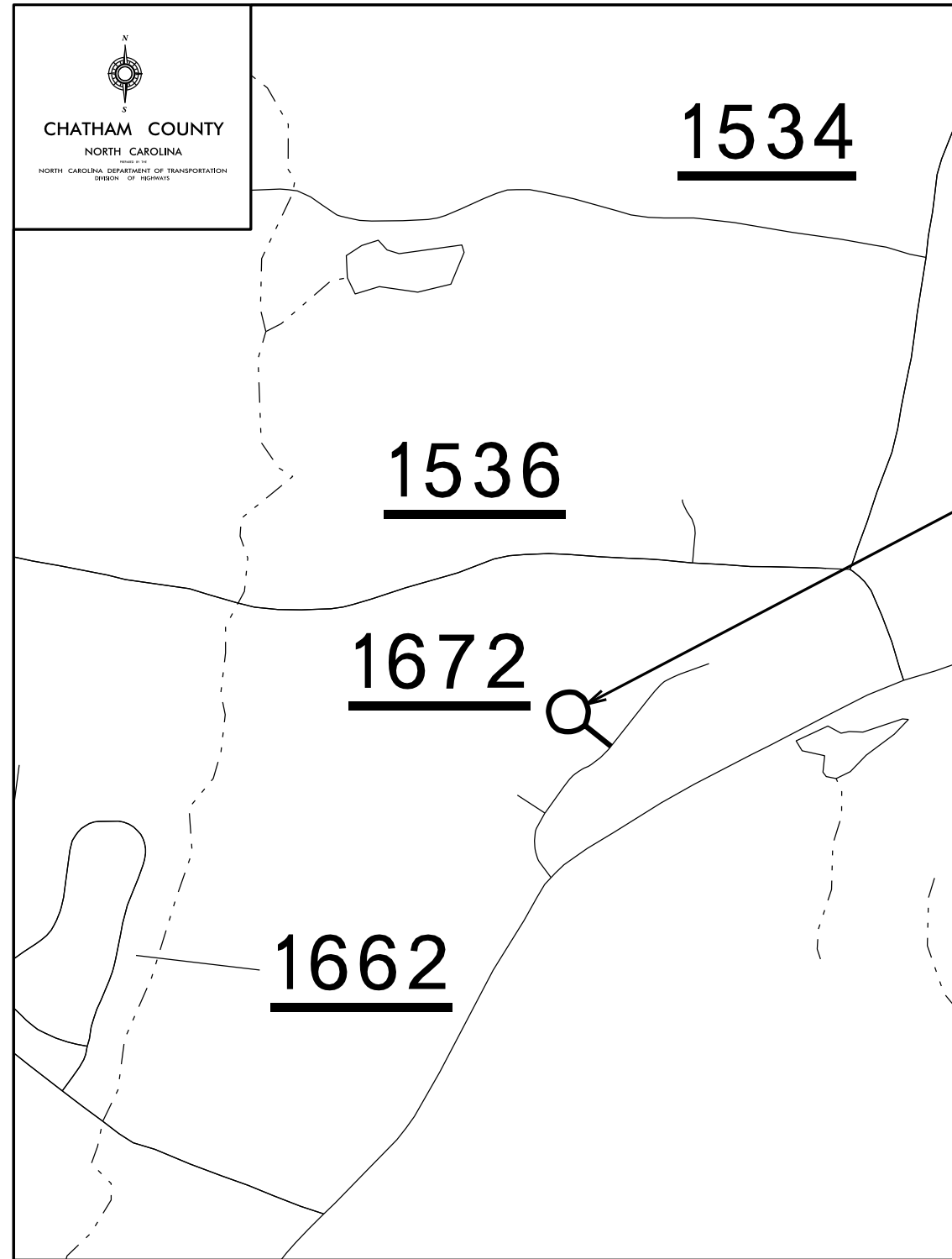

Map 31

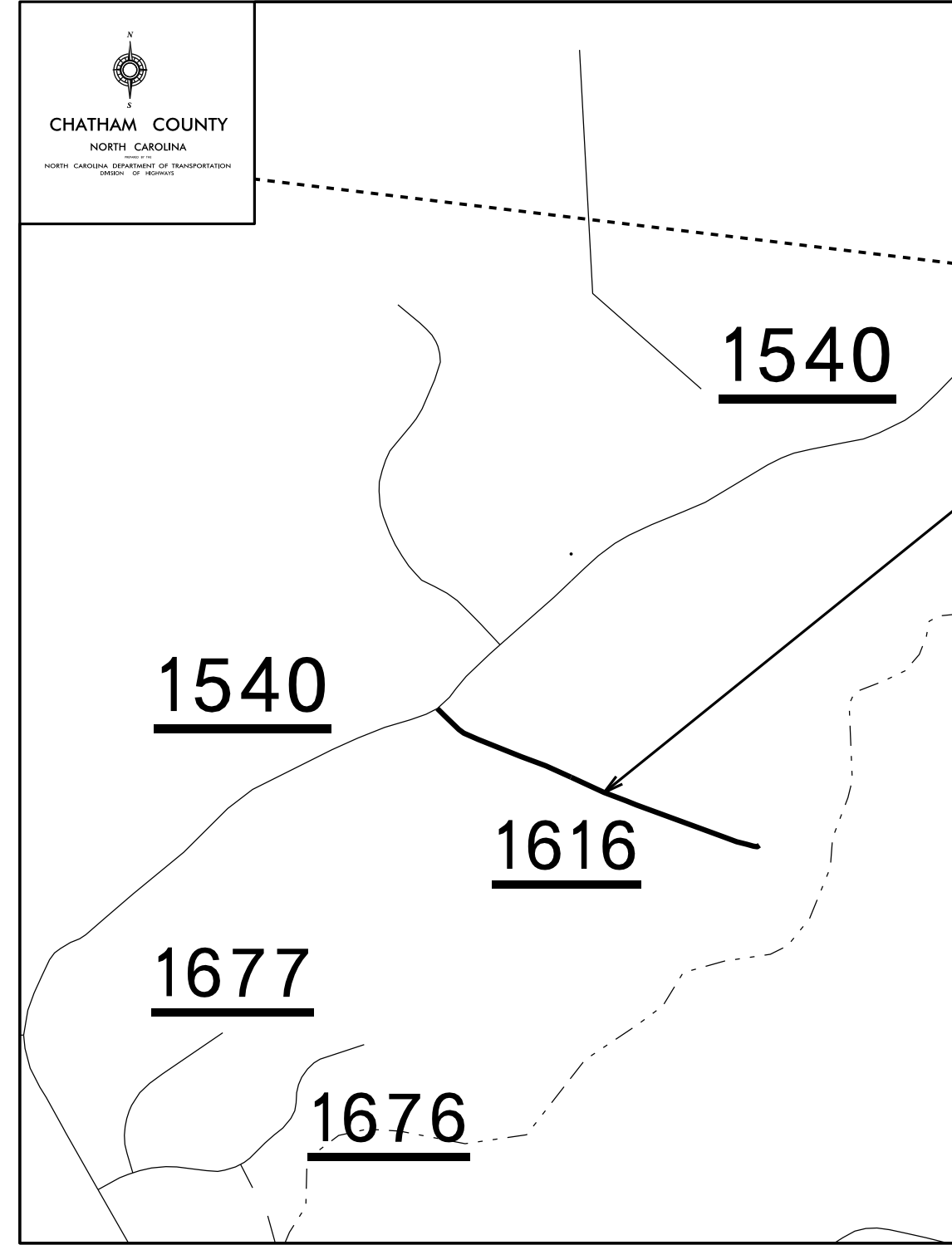

Maps 35,36

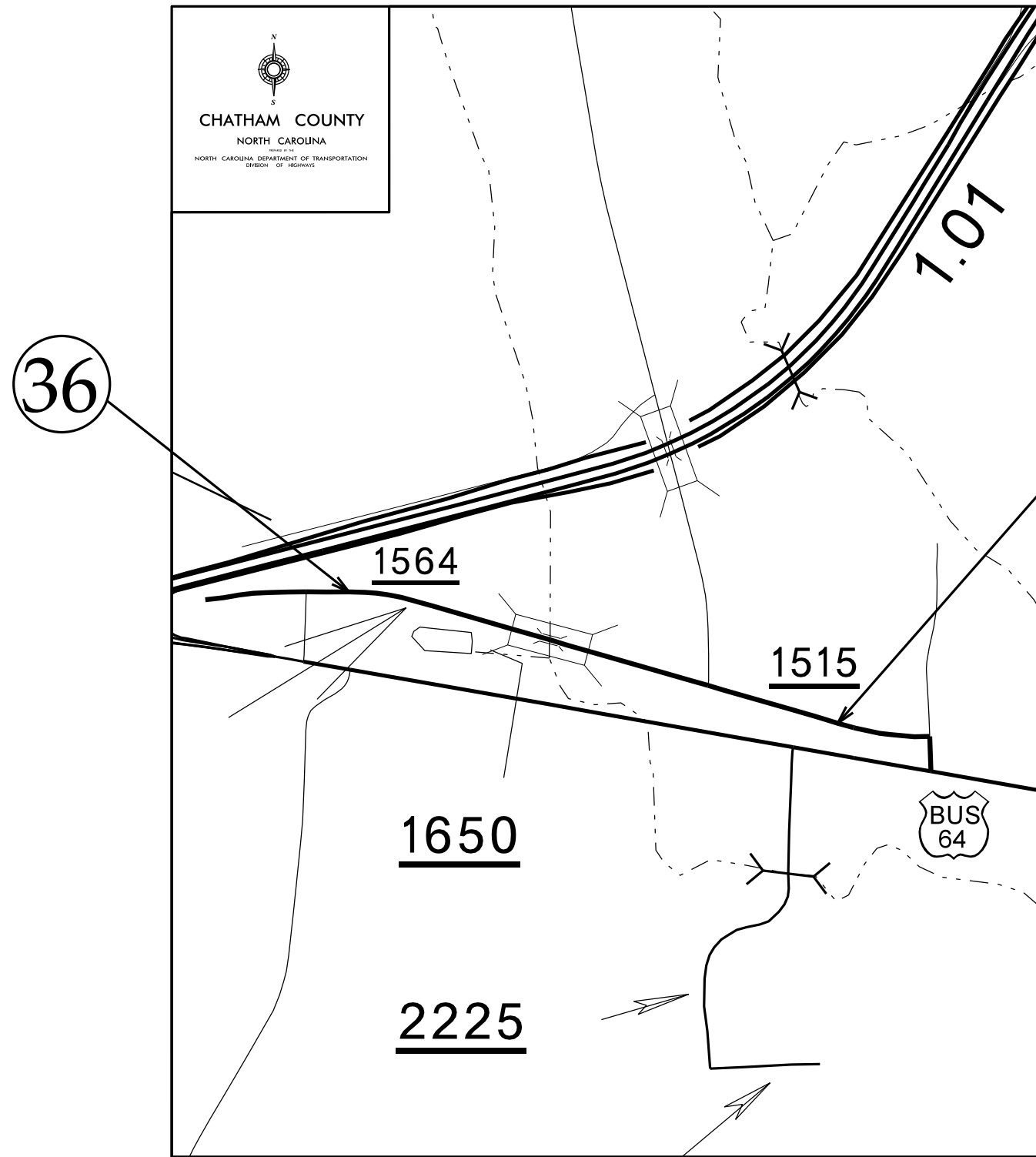

Maps 38,39

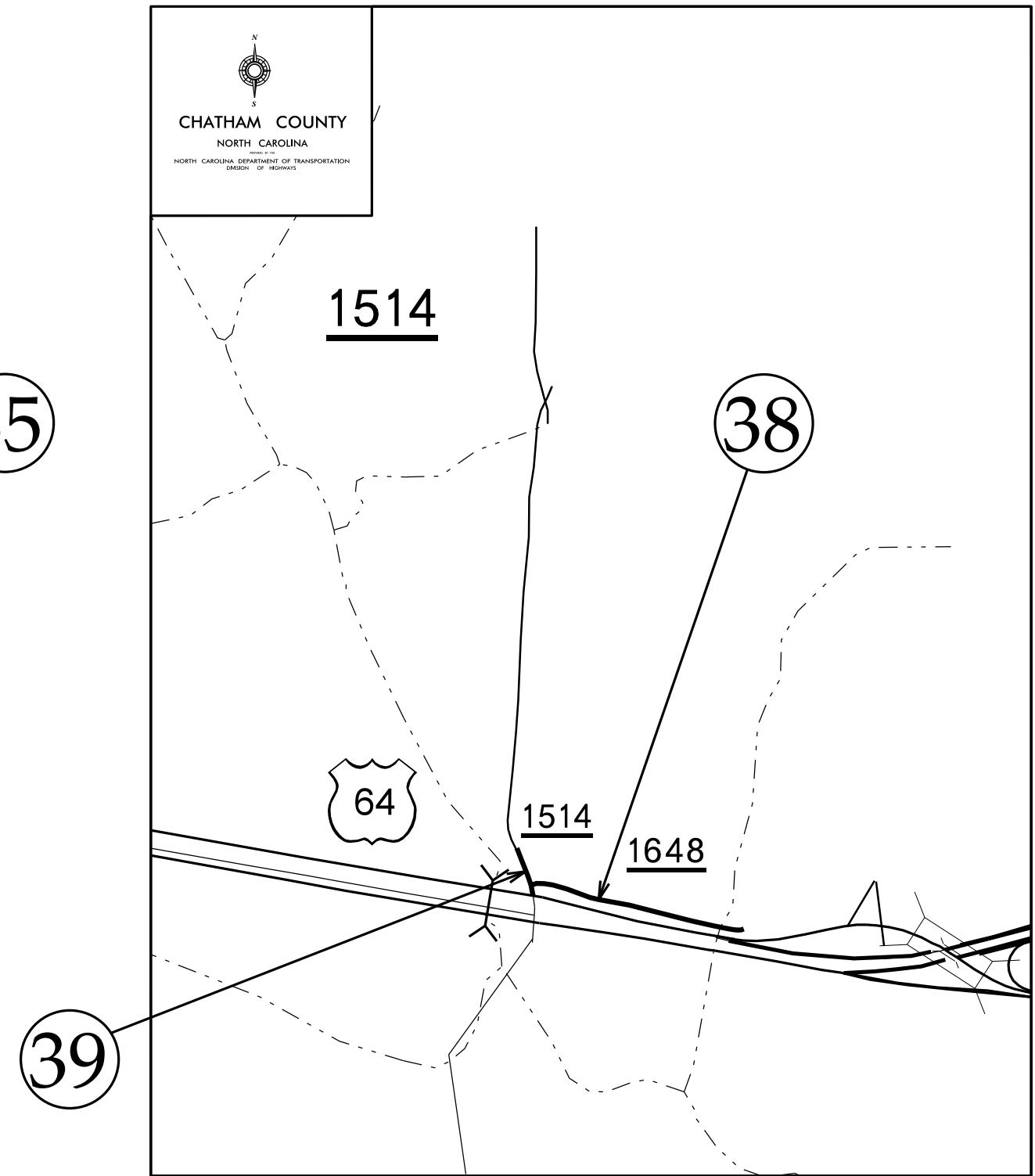

Maps 40,43

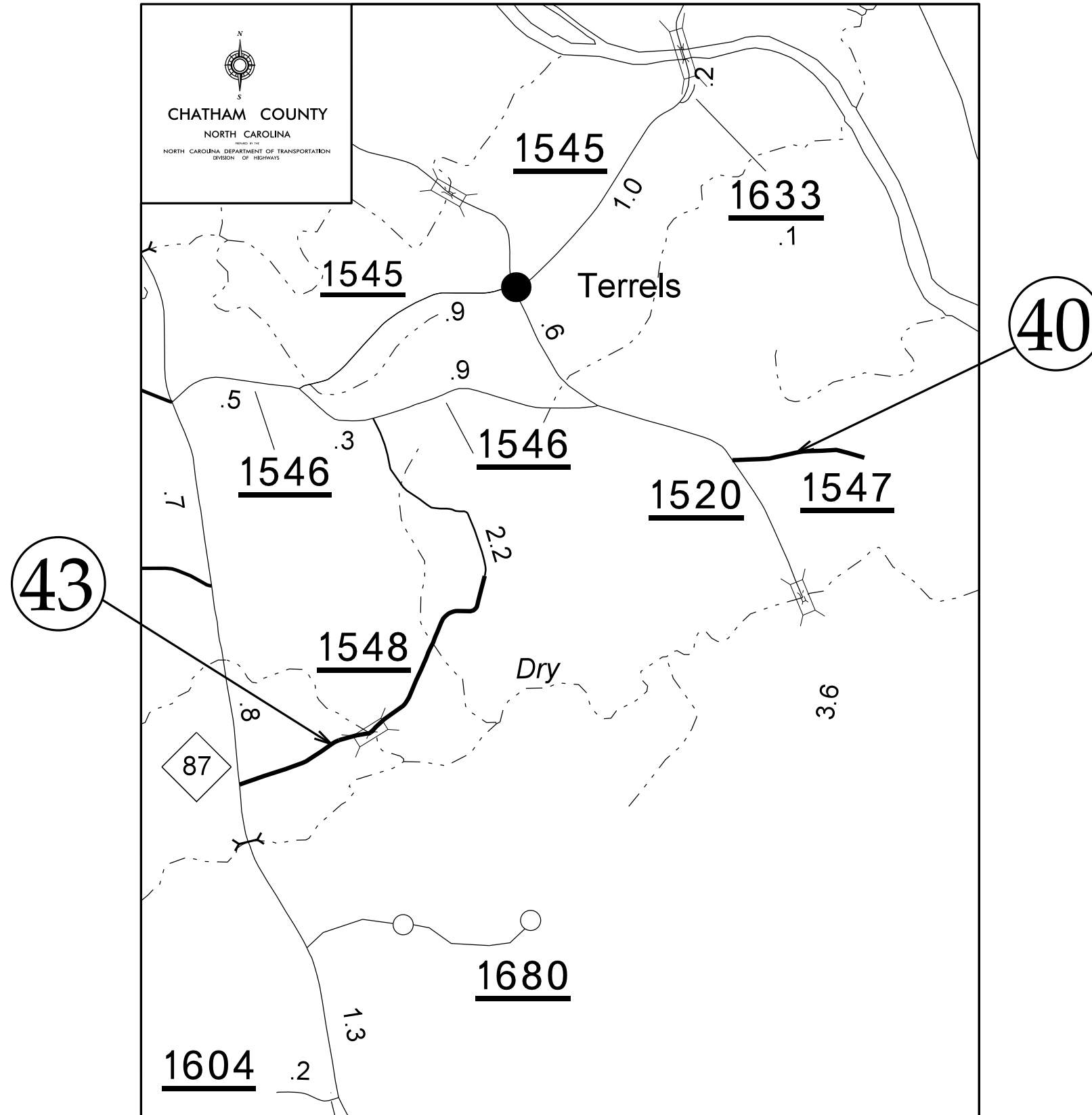

Maps 41,42

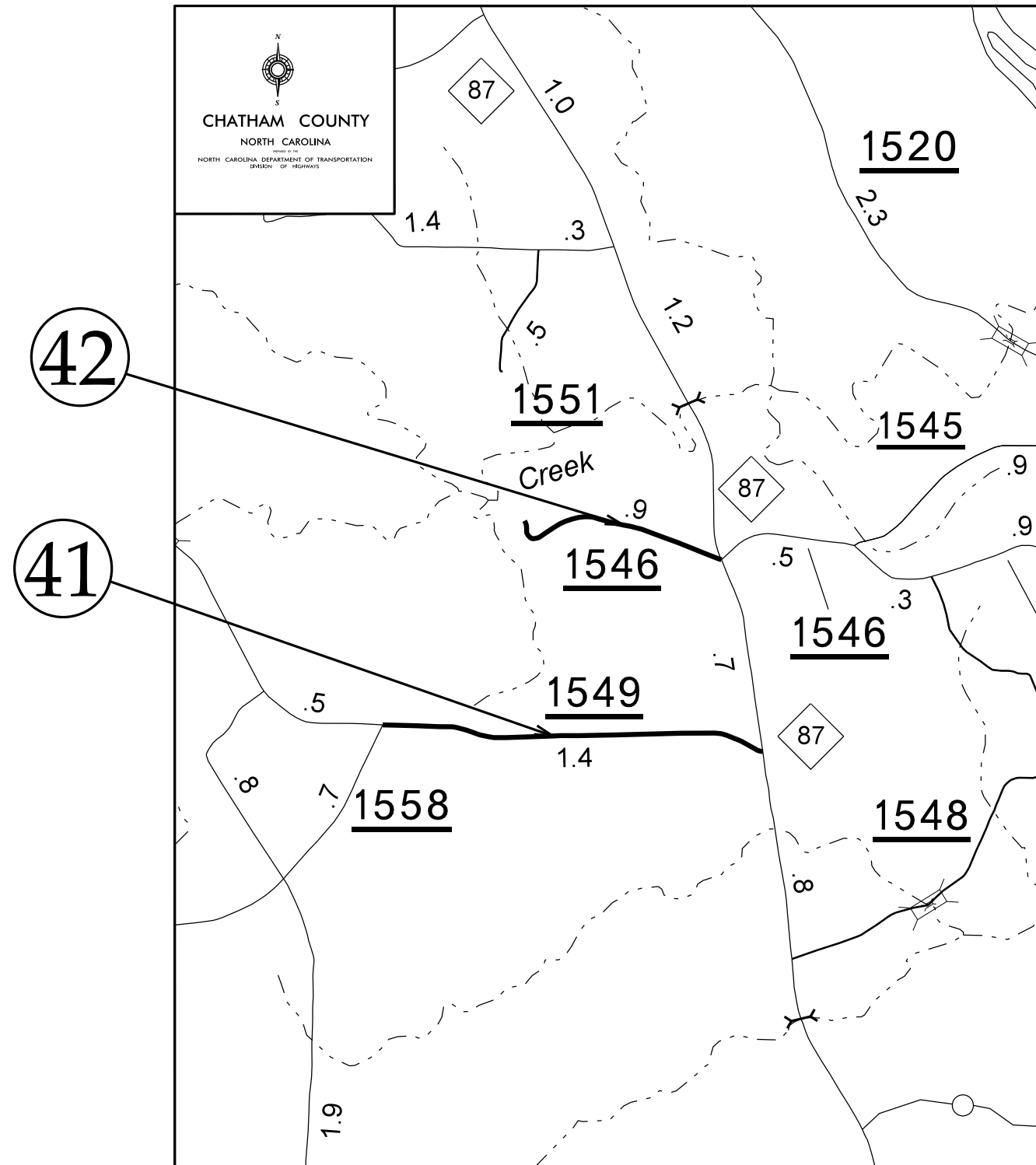

Maps 44,45

Map 46

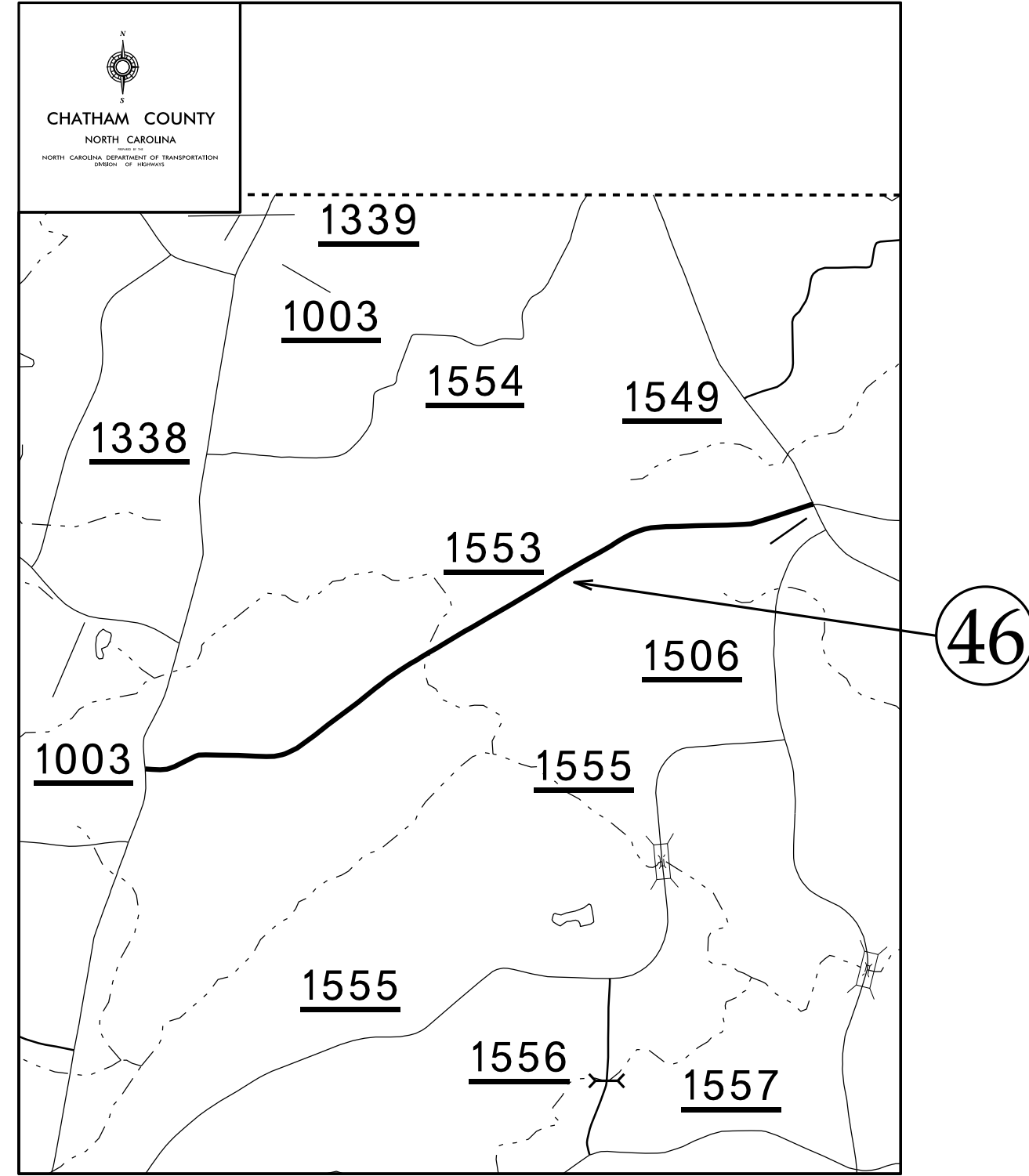
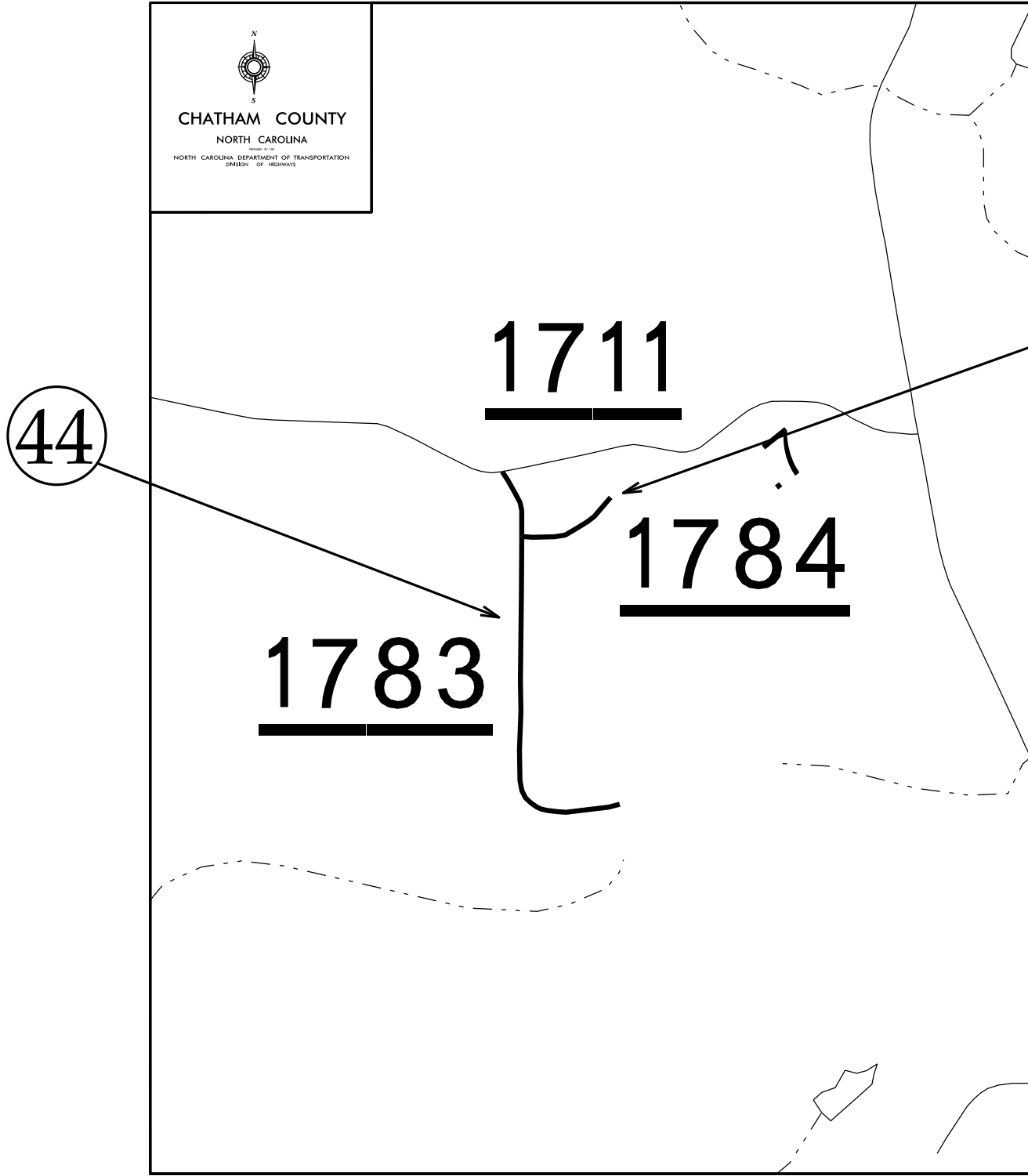

Maps 47

Map 48

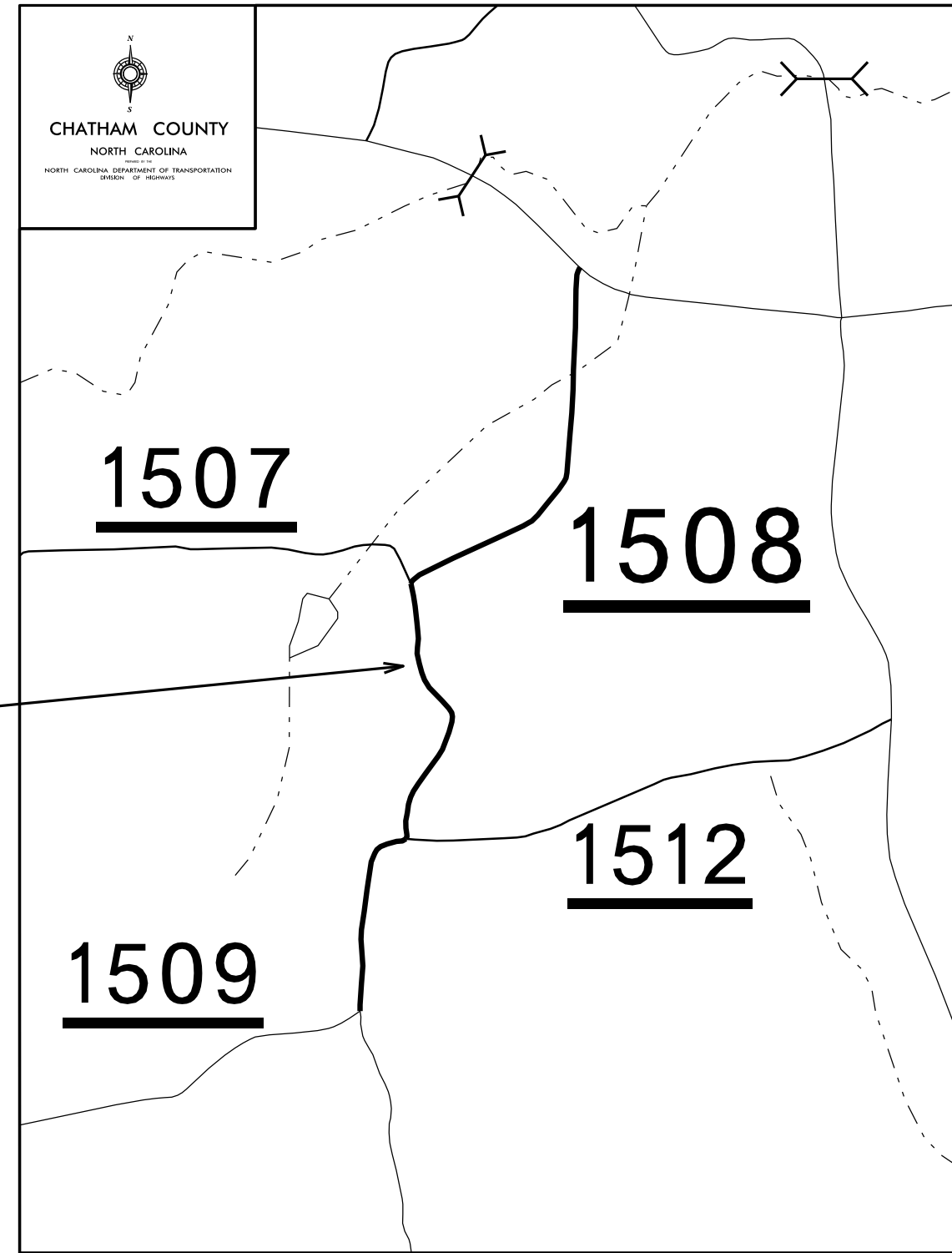
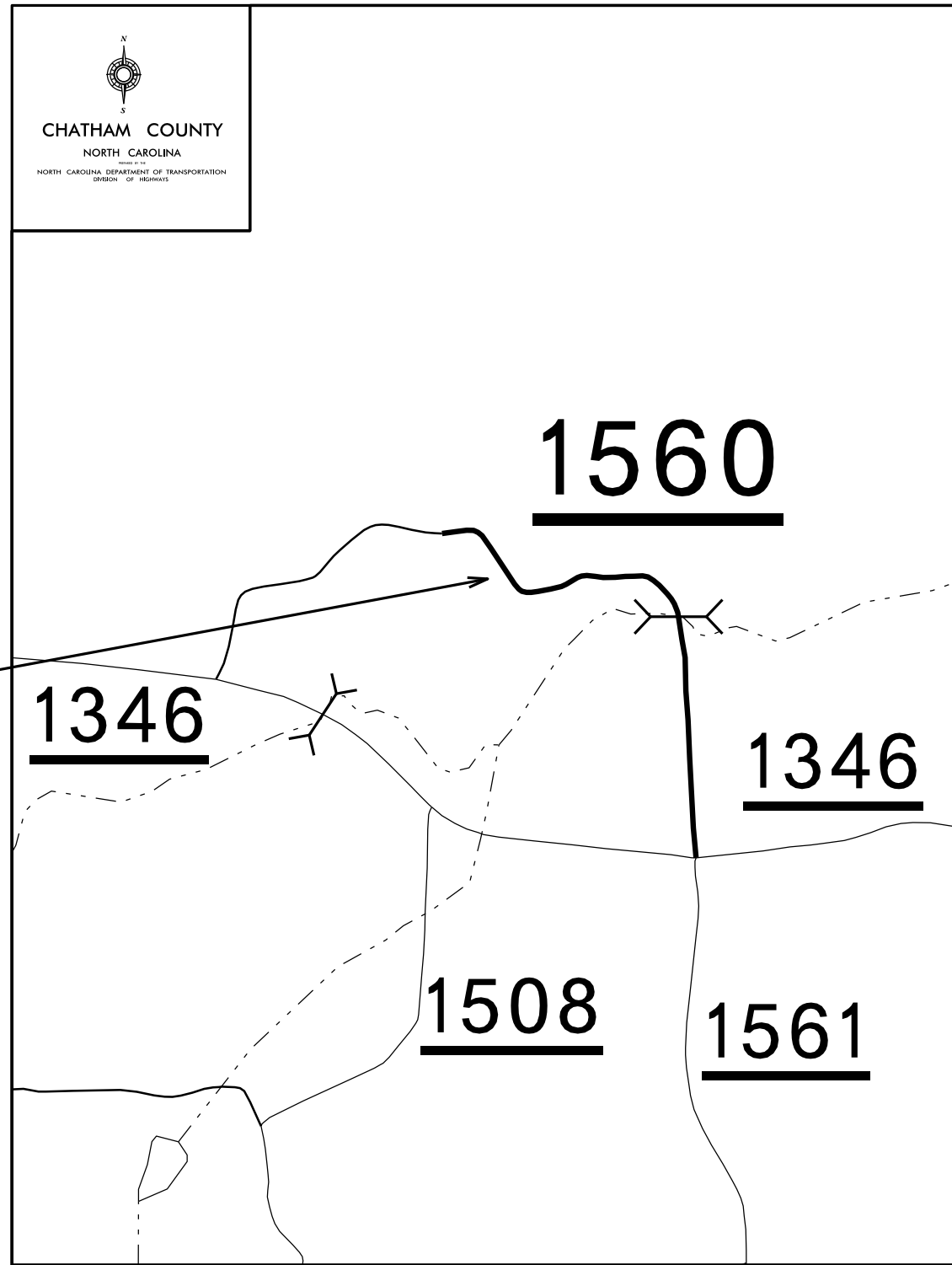

Map 49

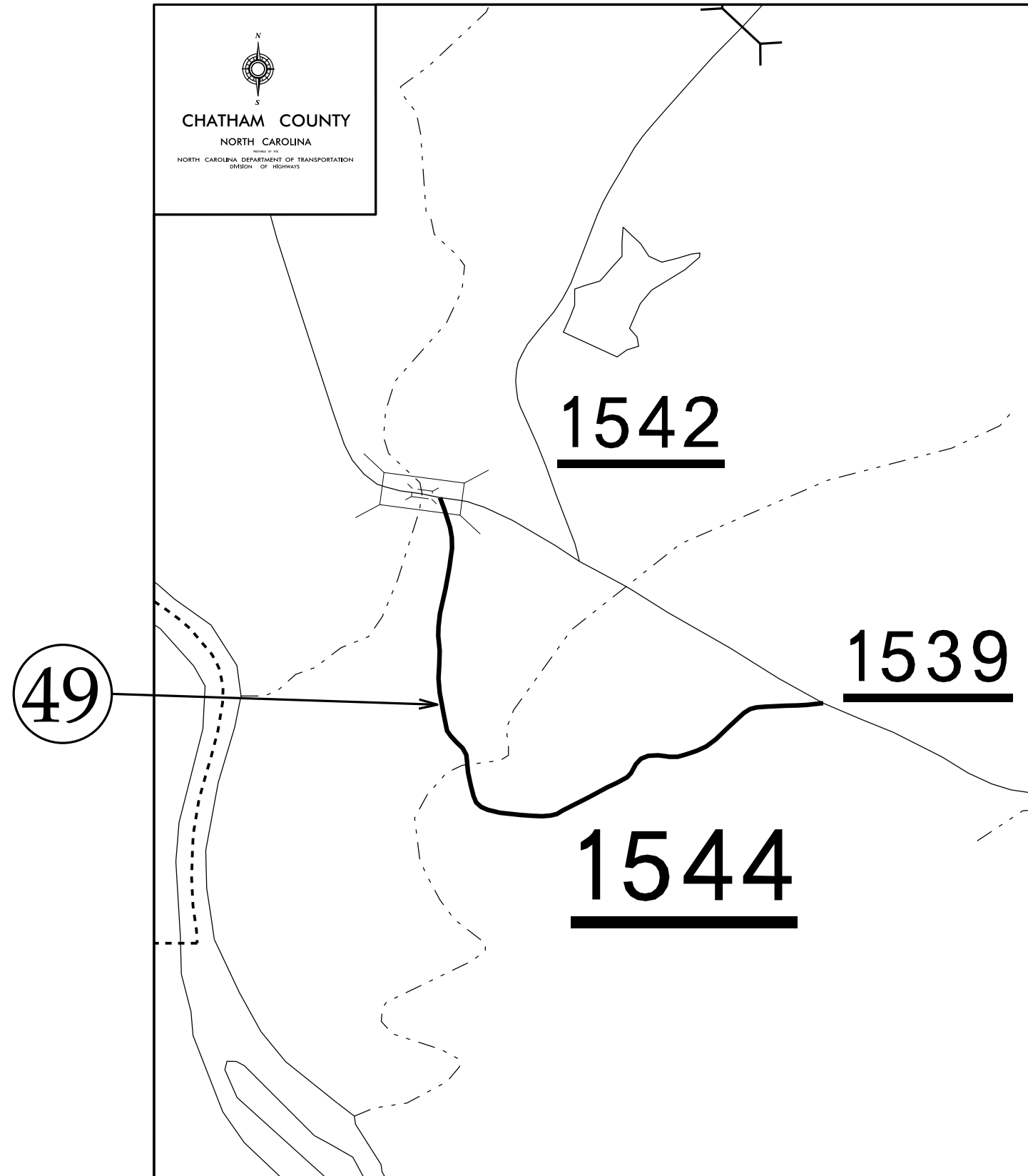

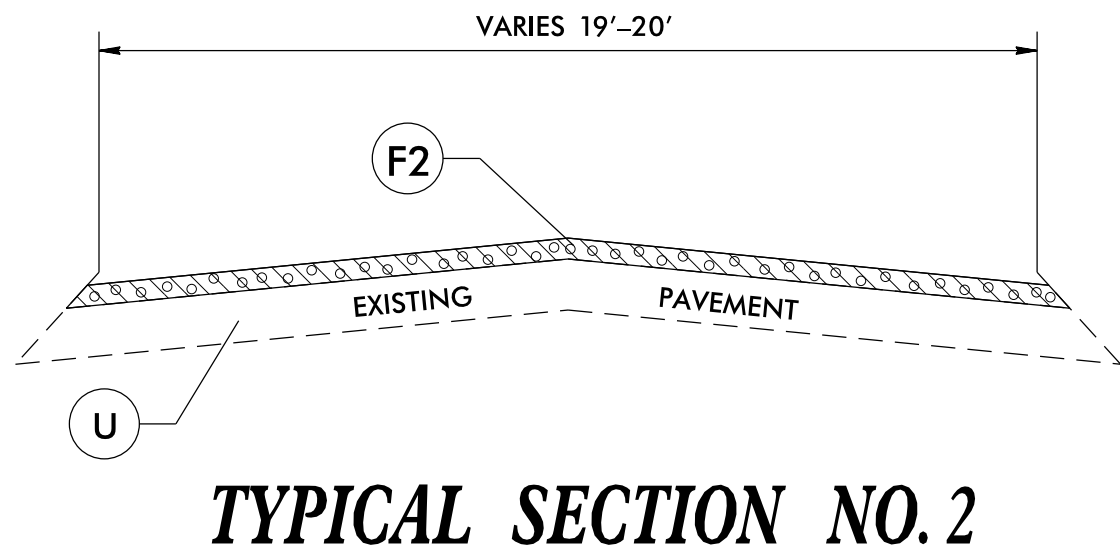
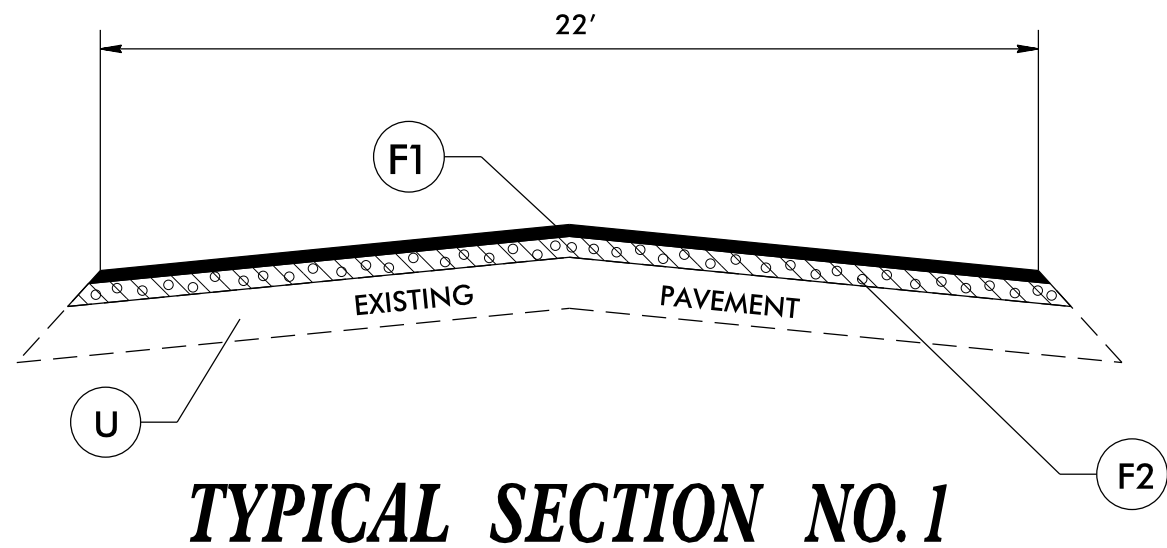

PAVEMENT SCHEDULE

F1	PROP. ASPHALT SURFACE TREATMENT, FOG SEAL
F2	PROP. ASPHALT SURFACE TREATMENT DOUBLE SEAL
U	EXISTING PAVEMENT

PROJECT NOTES

- FINAL PAVEMENT MARKINGS TO BE HANDLED BY STATE FORCES ON ALL MAPS.
- INCLUDE AST DOUBLE SEAL ON MAP 36 BRIDGE #422, MAP 43 BRIDGE #100.
- ALL PATCHING TO BE COMPLETED BY STATE FORCES.

SIGNING FOR ASPHALT SURFACE TREATMENT

LEGEND

- ◻ PORTABLE SIGN
- └ STATIONARY SIGN
- ← DIRECTION OF TRAFFIC FLOW

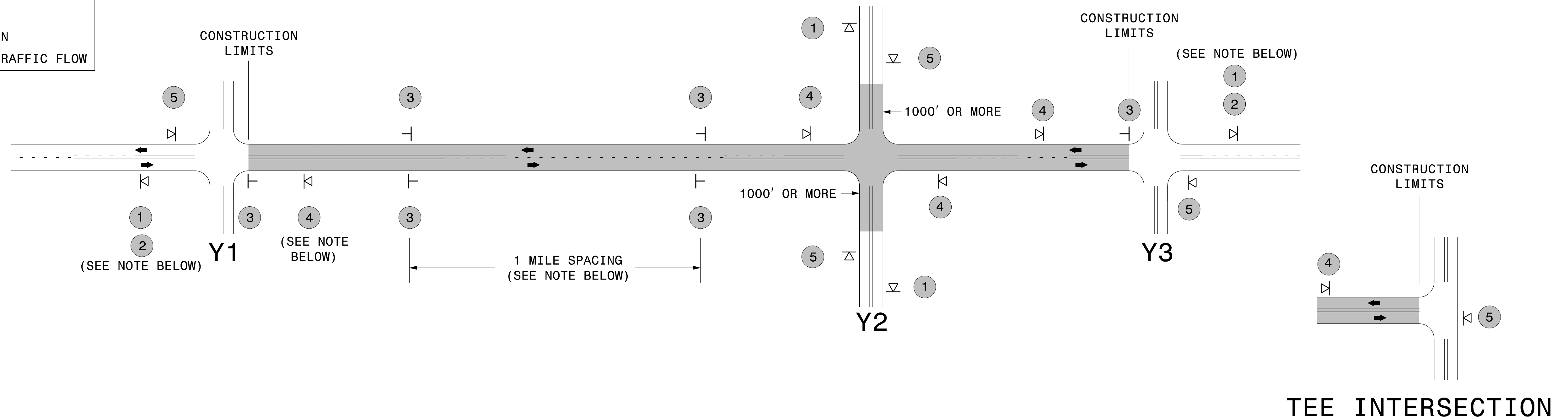

MAINLINE (-L-) SIGNING

-Y- LINE SIGNING

SIGNING NOTES AND PLACEMENT PER DIRECTION	1	 	<ul style="list-style-type: none"> - PLACE 1000' PRIOR TO BEGINNING OF CONSTRUCTION LIMITS. ONLY USED ON -Y- LINES IF RESURFACING LIMITS EXTEND 1000' ALONG -Y- LINE. - SIGN #2 ONLY USED WHEN RESURFACING LIMITS ARE 2 OR MORE MILES IN LENGTH. ROUND UP TO THE NEAREST WHOLE NUMBER. DO NOT USE FRACTIONAL OR DECIMAL NUMBERS. 	<p>STATIONARY SIGNING NOT REQUIRED FOR THE FOLLOWING -Y- LINE CONDITIONS:</p> <ol style="list-style-type: none"> 1) LESS THAN 1000' OF RESURFACING ALONG -Y- LINE 2) SUBDIVISION ROADS 3) DEAD END ROADS <p>WHEN PAVING/CONSTRUCTION ACTIVITIES PROCEED ACROSS AN UNSIGNED -Y- LINE, PORTABLE ADVANCE WARNING SIGNS SHALL BE USED ALONG THE -Y- LINE AS SHOWN BELOW. REMOVE UPON COMPLETION OF WORK.</p> <div style="display: flex; justify-content: space-around; align-items: center;"> <div style="text-align: center;"> <small>W20-1 48" X 48"</small> PLACED 500' IN ADVANCE OF FLAGGER. </div> <div style="text-align: center;"> <small>W20-7 A 48" X 48"</small> PLACED 250' IN ADVANCE OF FLAGGER. </div> </div>
	3	 	<ul style="list-style-type: none"> - ALTERNATE THE FOLLOWING TWO SIGNS: - STARTING WITH "LOOSE GRAVEL" (W8-7) FOLLOWED BY "UNMARKED PAVEMENT". - PLACE INITIALLY AT THE CONSTRUCTION LIMITS AND SPACED 1 MILE APART THEREAFTER. - AT TEE INTERSECTIONS INSTALL INITIALLY 0.5 MILE FROM INTERSECTION AND SPACE 1 MILE APART THEREAFTER. 	
	4		<ul style="list-style-type: none"> - THESE ARE FOR -Y- LINES THAT ARE "THROUGH" ROADWAYS. DEAD END AND SUBDIVISION ROADS ARE NOT "THROUGH" ROADWAYS. - INSTALL 500' +/- FROM EACH -Y- LINE APPROACH AS SHOWN ABOVE. - FOR MULTIPLE -Y- LINES THAT ARE SEPARATED BY 0.25 MILES OR LESS, TREAT AS A SINGLE UNIT AND INSTALL WITHIN 500' OF EACH APPROACH. - A MAXIMUM OF 2 SIGN SETS PER MILE. DO NOT INSTALL WHEN -Y- LINES ARE WITHIN 0.5 MILES FROM "END ROAD WORK" SIGN. 	
	5		<ul style="list-style-type: none"> PLACE 500' FOLLOWING THE END OF CONSTRUCTION LIMITS OR AS SHOWN WHEN WORK ENDS AT A 3-WAY TEE INTERSECTION. 	
	<p>THE ABOVE SIGNS ARE ALL THAT ARE REQUIRED FOR A CONTRACTOR TO BEGIN A RESURFACING CONTRACT. ANY ADDITIONAL SIGNS REQUESTED BY NCDOT DIVISIONS SHALL BE INSTALLED WITHIN 7 BUSINESS DAYS OF THE START OF CONTRACT WORK.</p>			

MAPS LESS THAN 2 MILES

FOR AST RESURFACING MAPS WITH CONSTRUCTION LIMITS LESS THAN 2 MILES IN LENGTH, USE A STATIONARY "LOOSE GRAVEL" SIGN AT THE BEGINNING CONSTRUCTION LIMIT FOLLOWED BY AN "UNMARKED PAVEMENT" SIGN MIDWAY THROUGH AND AN "END ROAD WORK" SIGN AT THE END CONSTRUCTION LIMIT.

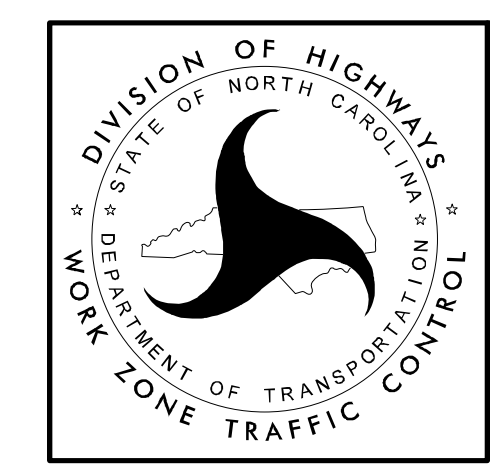

ADVANCE WARNING SIGNS FOR 2-LANE ROADWAY ASPHALT SURFACE TREATMENT

5/12/2017 S:\TMS\WZTC\Resurfacing\2L2W & AST Resurfacing Details\Resurfacing_AdvWarn_2Ln - AST.dgn User:kdais